

# Folklore of East Asia

*A Tribute to Roger L. Janelli*

Volume 38 Number 1 2008

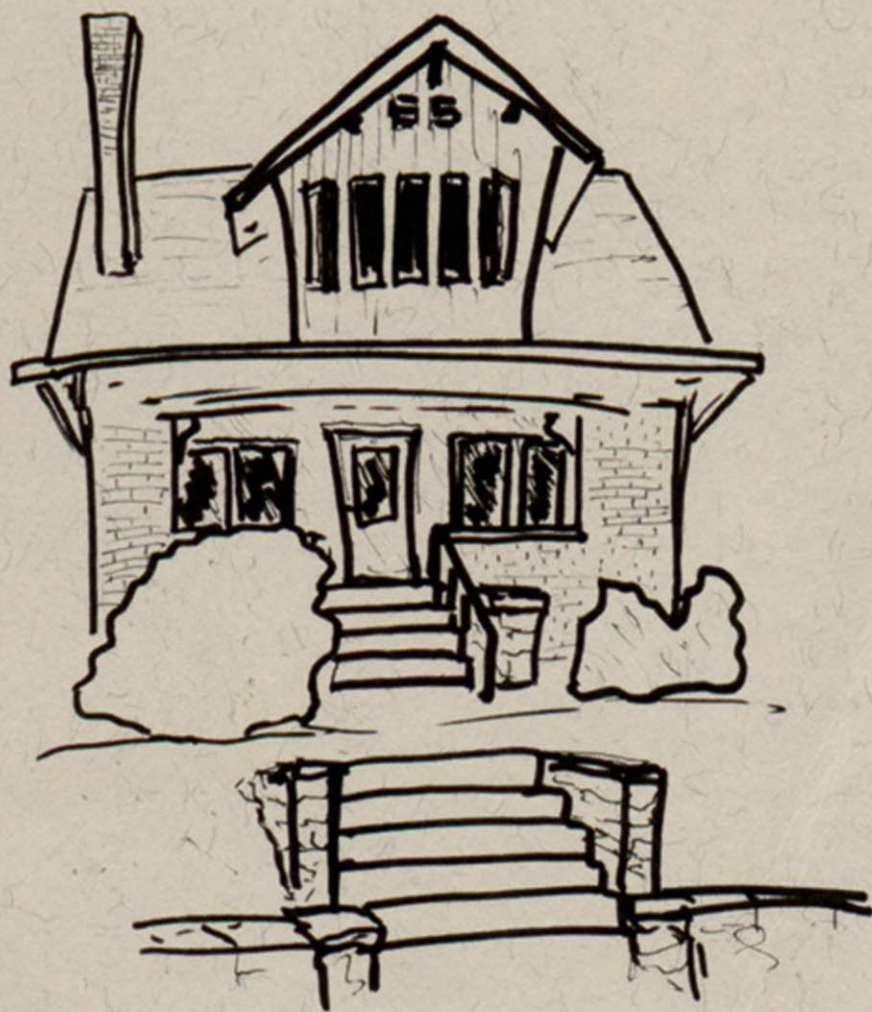

**Editor-In-Chief**

Elizabeth A. Burbach

**Guest Editor**

Kyoim Yun

**Assistant to the Editor**

Rachael Gonzalez

**Assistant Editor**

Kate Schramm

**Copy Editors**

Sarah Gordon

Tabatha Lingerfelt

Jeremy Stoll

Jessica Mayo

**Reviews Editor**

Kristiana Willsey

**Intern**

Jessica Mayo

**Webmasters**

Juan Eduardo Wolf

Kate Schramm

On our cover: 501 N. Park, Bloomington, Indiana, the longtime home of *Folklore Forum*. Drawing by John Fenn.

---

**BACK ISSUES** are archived on IUScholarworks Repository, located at <https://scholarworks.iu.edu/dspace/handle/2022/1168>. Hardbound copies are available on a limited basis for \$8.00/single or \$12.00/double. Contact us for shipping and handling.

**MANUSCRIPTS:** *Folklore Forum* publishes interdisciplinary articles on any aspect of folklore, folklife, or ethnomusicology according to the following submission guidelines.

**Scholarly Papers:** Interdisciplinary, academic research with a focused interpretation or analysis grounded in vernacular materials--verbal, material, customary, or musical. Suggested length is under 10,000 words. **Reflective Essays:** Short essays rooted in experience or practice--ethnographic fieldwork and collecting, educational or public sector applications. Suggested length is under 5,000 words. **Collectanea:** One or more items--textual or visual media--that present the materials of folklore and ethnomusicology. Excerpts considered. **Open Forum:** Brief and pertinent essays addressing topical or neglected issues in the disciplines of folklore and ethnomusicology. Dialogue and debate. Suggested length is 3,000 words or less.

**Reviews:** reviews of recent books; periodicals; festivals; conferences; exhibits; film; and broadcast, electronic, and recorded media. Suggested length is 500 to 1000 words. Review essays of multiple items will be considered--1,000 to 1,500 words. Essays that combine two or more of these general categories are encouraged.

All Submissions should conform to The Chicago Manual of Style using parenthetical citations. Since manuscripts are refereed anonymously, the author's name should appear along with brief contributor information (not exceeding fifty words) on the title page only. Submissions should be electronically mailed as attachments in Microsoft Word format to [folkpub@indiana.edu](mailto:folkpub@indiana.edu). Please contact us or see our website for further details, [www.folkloreforum.net](http://www.folkloreforum.net).

# **FOLKLORE FORUM**

Volume 38 Number 1 2008

## **CONTENTS**

### ***Folklore of East Asia*** ***A Tribute to Roger L. Janelli***

<i>From the Editor-in-Chief</i> ELIZABETH A. BURBACH	4
<i>From the Guest Editor</i> KYOIM YUN	5

## **ARTICLES**

<i>Japanese Folklore Studies and History: Pre-War and Post-War Inflections</i> ADAM BRONSON	8
<i>"Neither Fish nor Fowl": Constructing Peranakan Identity in Colonial and Post-Colonial Singapore</i> PATRICIA ANN HARDWICK	36
<i>Performing the 'Traditional' in the South Korean Musical World</i> HILARY FINCHUM-SUNG	55
<i>Liminal States: Life as an Indie Musician on Taiwan</i> MACK HAGOOD	82
<i>Conversation with Roger L. Janelli</i> SUE-JE LEE GAGE	102

## REVIEWS

- Essentials of Neo-Confucianism:  
Eight Major Philosophers of the Song and Ming Periods*  
(Huang Sui-chi)  
LANLAN (DIANE) KUANG 105
- Hans Christian Andersen: The Misunderstood Storyteller*  
(Jack Zipes)  
STEVE STANZAK 108
- The Robber with a Witch's Head:  
More Stories from the Great Treasury of Sicilian Folk and Fairy Tales*  
(Laura Gonzenbach)  
DAVID ELTON GAY 110
- Unmasking Class, Gender, and Sexuality in Nicaraguan Festival*  
(Katherine Borland)  
ELIZABETH A. BURBACH 112

## CONTRIBUTORS 115